

MFC-C

Flexible couplings

MFCS-C



Features

- Ideal one-body metallic spring flexible couplings.
- Zero backlash.
- Complete absorption of eccentricity angularity, and end-play by spring action.
- High torsional stiffness and response.
- Identical clockwise and anticlockwise rotational characteristics.
- Maintenance-free, oil and chemical resistant.
- Clamp type.
- MFC-C Body : Extra Super Duralumin.
- MFCS-C Body : Stainless steel.

特性

- 完美單一本體，撓性聯軸器。
- 零作用力。
- 藉由彈性作用，完美吸收軸偏移、角偏差、軸端部位插。
- 高扭力，高負荷
- 可正逆轉特性。
- 免保養、抗油、抗化學性。
- 夾鉗式固定。
- MFC-C 本體：鋁合金材質。
- MFCS-C 本體：不銹鋼材質。

Specifications

unit:mm

Product No 產品編號	Rated Torque 常用扭矩 (N.m)	Max. Torque 最大扭矩 (N.m)	Max. Rotational Frequency 最高迴轉數 (min ⁻¹)	Moment* Of Inertia 慣性 (kg.m ²)	Error of Eeccentricity 容許偏心量 (mm)	Error of Angularity 容許角偏差 (°)	Error of Shaft End-play 容許軸向位差 (mm)	Mass** 質量 (g)
MFC-16C	0.3	0.6	9500	3.5×10 ⁻⁷	0.10	2°	±0.4	9.1
MFC-20C	0.5	1.0	7600	8.7×10 ⁻⁷	0.10	2°	±0.4	16.5
MFC-25C	1.1	2.2	6100	2.2×10 ⁻⁶	0.15	2°	±0.5	29.0
MFC-32C	2.0	4.0	4800	9.1×10 ⁻⁵	0.15	2°	±0.5	67.0
MFC-40C	5.0	10.0	3800	2.9×10 ⁻⁴	0.20	2°	±0.5	138.0
MFC-50C	10.0	20.0	3100	1.3×10 ⁻⁴	0.20	2°	±0.5	260.0
MFCS-16C	0.5	1.0	9500	9.2×10 ⁻⁷	0.10	2°	±0.3	27.0
MFCS-20C	1.0	2.0	7600	2.5×10 ⁻⁶	0.10	2°	±0.3	45.0
MFCS-25C	2.1	4.2	6100	7.4×10 ⁻⁶	0.15	2°	±0.4	87.0
MFCS-32C	3.5	7.0	4800	2.7×10 ⁻⁵	0.15	2°	±0.5	180.0

*Max. Bore Moment of Inertia/最大孔徑時慣性矩

**Max. Bore Mass/最大孔徑時質量

Clamp type

● MFC-C

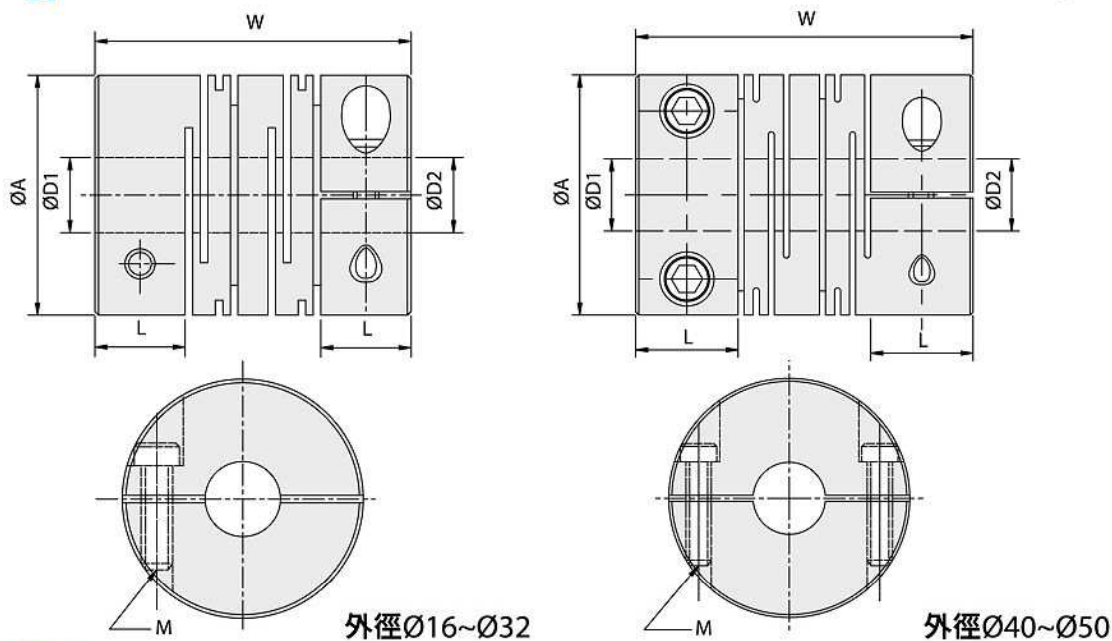

Dimension

unit:mm

Product No 產品編號	A	L	W	Stock Bores 標準孔徑 D1×D2(公差 H8)		M
				Min D1	Max D2	
MFC-16C	16	6.5	23	5	6	M2.5
MFC-20C	20	7.5	26	5	8	M2.5
MFC-25C	25	8.5	31	5	10	M3
MFC-32C	32	12	41	6	14	M4
MFC-40C	40	17	56	8	16	M5
MFC-50C	50	21	71	12	18	M6
MFCS-16C	16	6.5	23	5	6	M2.5
MFCS-20C	20	7.5	26	5	8	M2.5
MFCS-25C	25	8.5	31	5	10	M3
MFCS-32C	32	12	41	6	14	M4

When Ordering

When placing an order, make sure to include product no.
And stock bores(both sides) of product.

MFC-25C - Ø6 X Ø6

Product No D1 D2